

GREENEFIELD

IN CARTERSVILLE, GA

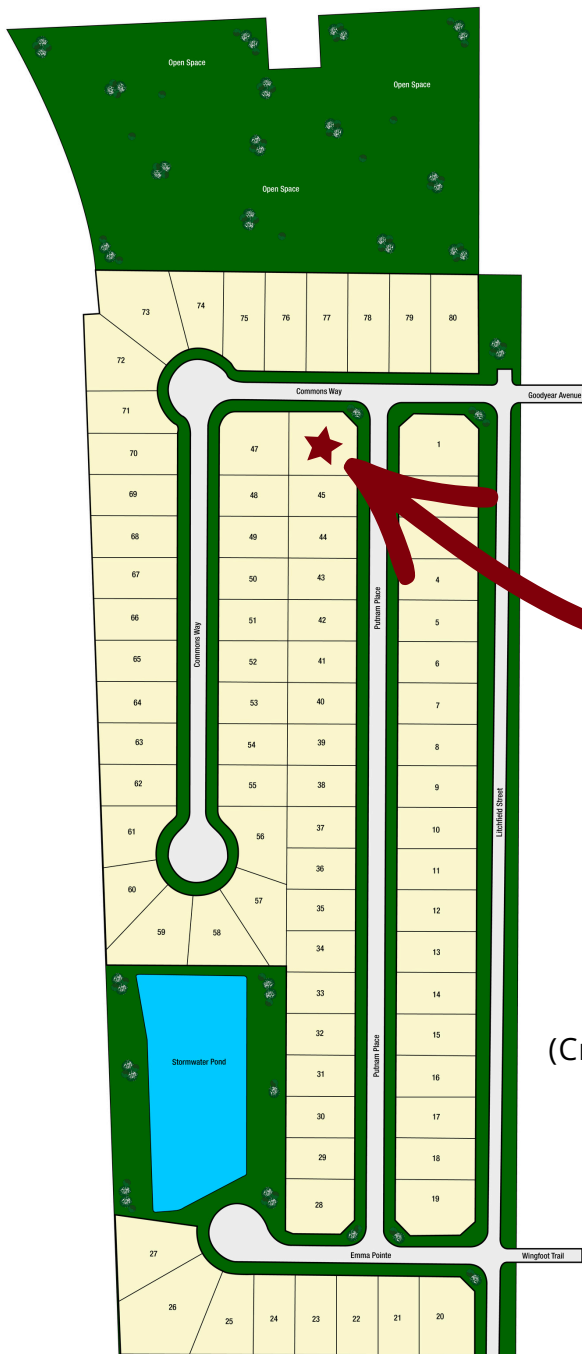

Model Home Here!

New Homes From the \$400K+

Model Home Lot 46:
 4 Putnam Place
 Cartersville, GA 30120
 (Cross streets: Litchfield Street
 & Goodyear Ave)



COMMUNITY FEATURES:



3 Car Garages



Gainesville, GA



Green Space

CALL FOR AN APPOINTMENT TODAY!



onlinespecialist@chafinrealtyinc.com



www.chafincommunities.com



470-269-3829

ABOUT THE COMMUNITY:

Greenefield is conveniently located just off Litchfield Street and is located in the Cartersville School District. This intimate community will feature 80 homesites, creating a welcoming environment where neighbors can truly feel connected. With no community amenities, Greenefield is ideal for buyers who value simplicity, lower HOA costs, and the freedom to enjoy nearby parks, local attractions, and everything the greater Cartersville area has to offer.

Each home at Greenefield will reflect Chafin Communities' commitment to quality craftsmanship, modern design, and functional layouts built for today's lifestyles. Buyers will have the opportunity to choose a home that fits their needs, whether that means open-concept living, flexible spaces for working from home, or comfortable outdoor areas for relaxing and entertaining.